

# RY100 & RY200 PARTS LIST

- 1- RY39 Lamp Kit
- 2- RY9069 Cap Screw
- 3- RY10038 A.C. Motor
- 4- RY10033 Motor Mounting Plate
- 5- RY111 or RY222 Slotter Kit (optional)
- 6- RY118 or RY218 Standard QC Stylus
- 7- RY9048 Set Screw
- 8- RY10037 Motor Pulley
- 9- RY9039 Drive Belt
- 10- RY118 or RY218 Slotter Stylus
- 11- RY115 Slotter Cutter
- 12- RY9061 Phillips Screw
- 13- RY10016 Belt Guard
- 15- RY101 Wire Brush Kit (optional)
- 16- RY9074 Replacement Wire Brush
- 17- RY10101 Arbor
- 18- RY10030 or RY20030 Cutter
- 19- RY10036 Cutter Hex Nut (Left Hand)
- 20- RY9037 Ball Bearing Assembly
- 21- RY9054 Flat Head Screw
- 22- RY10012 Motor Bracket
- 23- RY9053 Strain Relief
- 24- RY9052 Bushing
- 25- RY10013 Guard
- 26- RY107 Cutter Shield (optional)
- 28- RY9042 Cap Screw
- 29- RY9029 Set Screw
- 30- RY10029 Stylus Adjustment Knob
- 31- RY9056 Nylon Lock Nut
- 32- RY10028 or RY20028 Stylus
- 33- RY9057 Cap Screw
- 34- RY9145 Rubber Foot
- 35- RY9058 Cap Screw
- 36- RY9024 Bronze Oilite™ Bearing
- 37- RY10010 Machine Base
- 38- RY9044 Cap Screw
- 39- RY92 Capacitor Assembly
- 41- RY9055 Hex Jam Nut
- 42- RY9041 Switch
- 44- RY10035 Cutter Shaft Lock
- 45- RY10017 Access Plate
- 48- RY84 Ball Bearing Spindle Assembly
- 49- RY80 Key Vise Knob & Stud
- 50- RY82 3-Piece Thrust Bearing Assy.

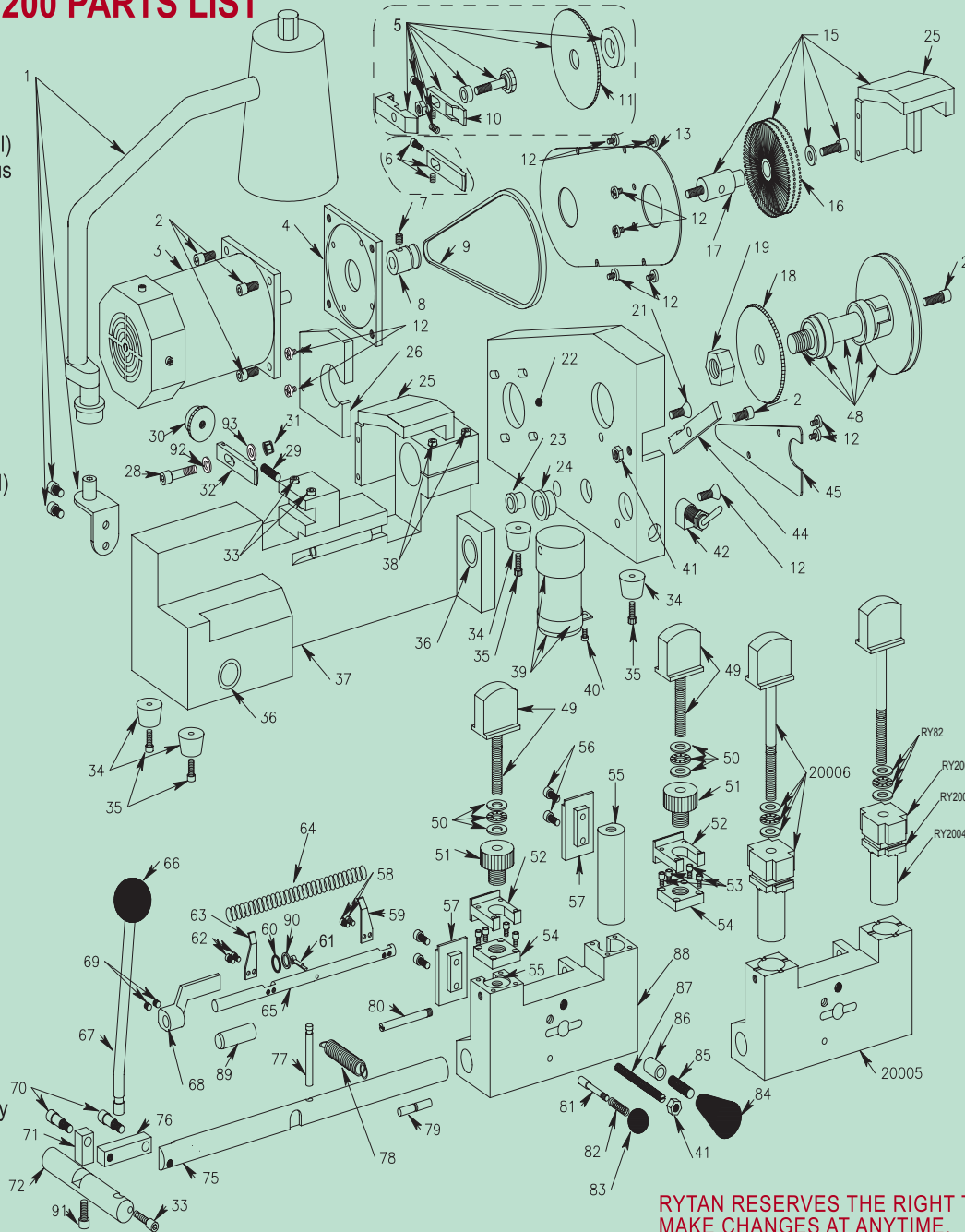

RYTAN RESERVES THE RIGHT TO  
MAKE CHANGES AT ANYTIME.

- 51-RY10041 Top Jaw Clamp Knob
- 52-RY89 or RY20089 Top Vise Jaw
- 53-RY9063 Cap Screw
- 54-RY10045 Top Plate
- 55-RY10046 Vise Plunger
- 56-RY9062 Cap Screw
- 57-RY10047 or 20047 Bottom Vise Jaw
- 58-RY9107 Slot Head Screw
- 59-RY10048 Key Gauge R.H.
- 60-RY9108 O-Ring
- 61-RY9279 Cotter Pin
- 62-RY9061 Cap Screw
- 63-RY10050 Key Gauge L.H.
- 64-RY10061 Key Gauge Spring
- 65-RY10049 Key Gauge Shaft
- 66-RY9027 Lever Knob
- 67-RY10018 Lever Shaft
- 68-RY114 Key Gauge Protector (optional)
- 69-RY9003 Set Screw
- 70-RY9059 Shoulder Screw
- 71-RY10020 Drive Link
- 72-RY10019 Drive Shaft
- 75-RY10022 Carriage Shaft
- 76-RY10021 Shaft Link
- 77-RY10026 Carriage Shaft Spring Pin
- 78-RY10025 Carriage Extension Spring
- 79-RY9200 Retaining Pin
- 80-RY10056 Key Ring Stud
- 81-RY10023 Carriage Release Stud
- 82-RY9025 Carriage Release Spring
- 83-RY9038 Carriage Release Knob
- 84-RY9028 Carriage Knob
- 85-RY10086 Threaded Stud
- 86-RY10060 Knob Spacer
- 87-RY10087 Carriage Over-Travel
- 88-RY10011 or RY20011 Carriage
- 89-RY9278 Vinyl Cap
- 90-RY10067 Flat Washer
- 91-RY9047 Cap Screw
- 92-RY9073 Washer
- 93-RY9106 Washer