

## RY23 ROTO PULLER INSTRUCTIONS

### UNIVERSAL STEERING WHEEL PULLER

(for American made cars- Dodge, GM, Ford & AMC)

#### PARTS LIST

RY2301	Body
RY2302	Thrust Screw Assembly
RY2303	One Pair 3/8"-16 Puller Bolts
RY2304	One Pair 5/16"-18 Puller Bolts
RY2305	One Pair 5/16"-24 Puller Bolts
RY2306	Instructions

Your new RY23 Roto Puller™ universal steering wheel Puller is for standard threaded (not metric) American Cars (Dodge, General Motors, Ford and American Motors).

#### INSTRUCTIONS

TO REMOVE STEERING WHEEL FROM STEERING SHAFT THE HORN ASSEMBLY AND STEERING SHAFT HEX NUT MUST BE REMOVED.

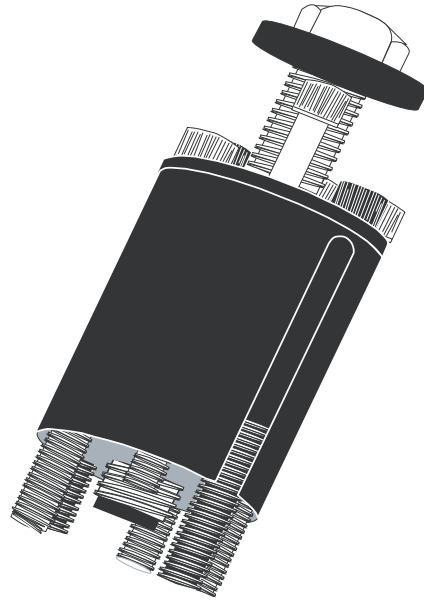

1. Your Rytan RY23 Roto Puller universal steering wheel puller can be used on conventional, tilting and telescoping steering columns.

#### NON-TELESCOPING STEERING COLUMN

2. If your steering column not telescoping, place your Rytan RY23 Roto Puller onto steering wheel, rotate tool to align correct size and threading of puller bolts with pre-tapped holes in steering wheel. Tighten symmetrically until Roto Puller alignment is straight. (Note: There are two Thread Sizes for 5/16" bolts; one coarse thread and the other is fine thread.) Make sure your selection is correct before using tool. Failure to do so will damage steering wheel and Roto Puller.

#### TELESCOPING STEERING COLUMN

2a. If your steering column is telescoping. Steering shafts with telescoping feature have tapped hole in center. Your RY23 Roto Puller has a built-in rotating tip thrust screw that will not damage the steering shafts center tapped hole. Be certain that your RY23's rotating tip is installed onto the thrust screw.

3. Use 13/16" open end wrench (not Supplied) to turn the hex head thrust screw until the steering wheel is pressed off the steering shaft.

4. Remove steering wheel and Roto Puller tool.

5. General Motors cars use Rytan's RY29 Roto Pusher to remove access plate and retaining clip. follow RY29 instructions that come with your Roto Pusher tool.

08.04.07