

RY81 KEY GAUGE INSTALLATION INSTRUCTIONS

for Rytan, Inc. Model Ry100, RY200, RY456 & RY256 High-Speed Semi-Automatic Key Duplicating Machines

INSTRUCTIONS

1. Left and Right key gauges must be installed as pictured. Key gauge shaft is illustrated in the "flipped up" position.
2. Always install the Right-hand key gauge (RY10048) with Slot head screws.
3. The O-Ring (RY9108) and Flat Washer (RY10067) are installed on one side of Cotter Pin (RY9279) as illustrated. The Key Gauge Spring (RY10061) is installed on the other side of the cotter Pin.

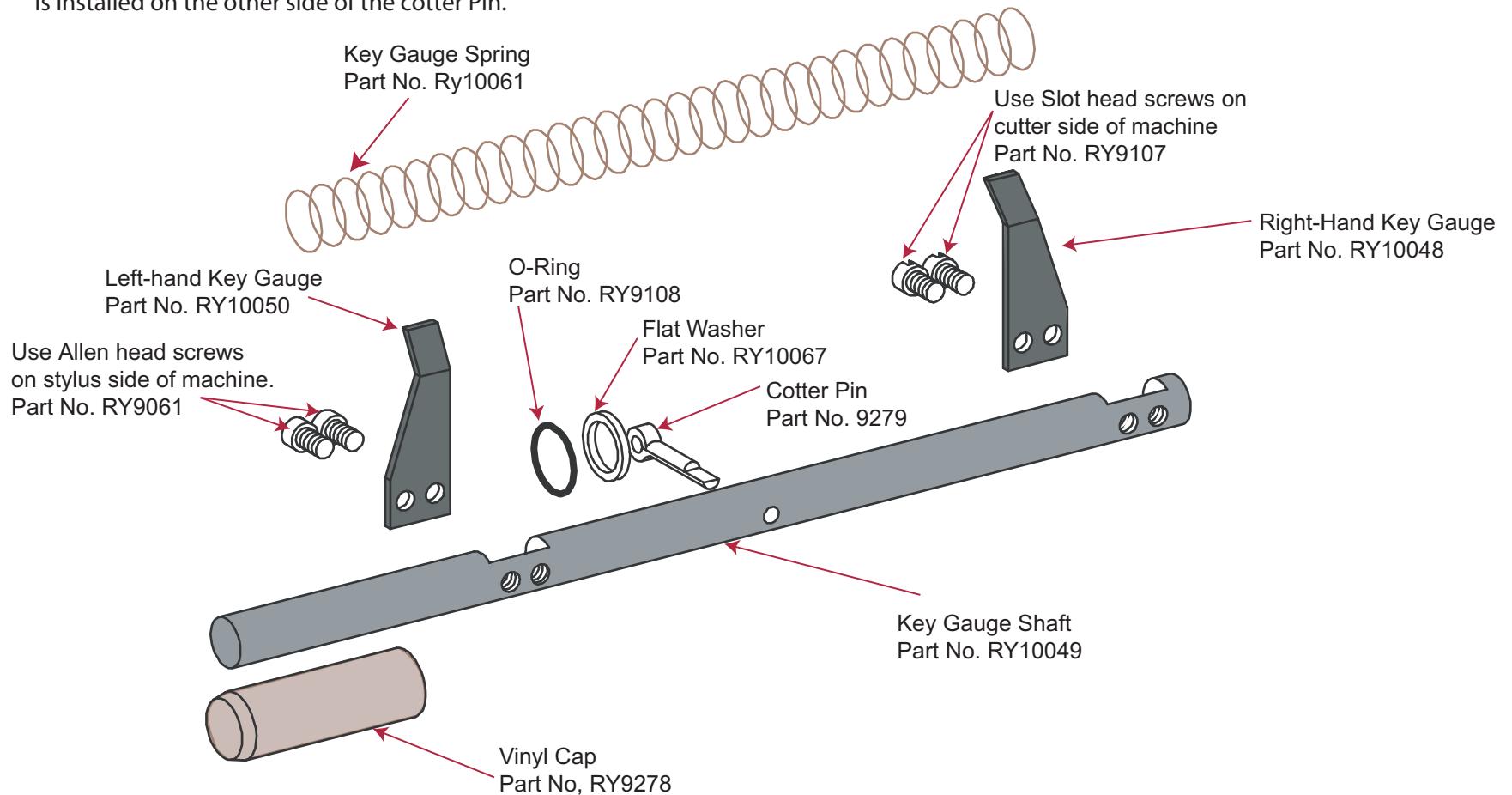

FOR TECHNICAL HELP CALL TOLL-FREE (800) 447-9826 9:00 AM TO 4:30 PM PACIFIC TIME MONDAY THRU FRIDAY